

Once you have registered and made payment arrangements at your level of sponsorship, please use the accompanying layout to select three booth choices out of the eighteen slots (numbered) shown and e-mail those to vendorsupport@waurisa.org. Please contact Tony Hartrich if you have any questions. vendorsupport@waurisa.org

Exhibitor Registration Options

	Mt. Olympus	Mt. Baker	Mt. Adams	Mt. Rainier
Cost	\$250	\$600	\$800	\$1000
Number of Booths	0	1	1	2
Conference Attendee Passes	0	1*	2*	3*
1 yr WAURISA Sponsorship	No	No	Yes	Yes
Logo & Listing in Program	Yes	Yes	Yes	Yes
Listing on Conference Webpage‡	Yes	Yes	Yes	Yes
Quarter Page Ad in Summit	No	No	Yes	No
Full Page Ad in Summit	No	No	No	Yes

*Additional attendee passes to conference can be purchased at a rate of \$175/person

‡Listing on Conference Webpage is separate from WAURISA sponsorship listings and limited in duration

Sponsorship Opportunities

If you would like to sponsor WAURISA beyond the scope outside of the exhibitor registration option packages, please request more information from Angela Johnson at: vendorsupport@waurisa.org. There are many opportunities to sponsor snack breaks, contribute to raffles, provide lanyards, pens, notepads, or help offset the costs of the social event.

Registration

Please register online at this secure website: [Online Thriva Registration](https://secure.thriva.com/Reg/Form.aspx?IDTD=7578&IDRPH=1359112)
<https://secure.thriva.com/Reg/Form.aspx?IDTD=7578&IDRPH=1359112>

We can also take your registration via phone or through the mail. Please contact Steve Schunzel if you are unable to register online treasurer@waurisa.org.

Logistics

Each booth reserved will consist of an area of 10' wide by 8' deep, with a draped table and chairs.

Electrical, Internet, and other services may be purchased directly from Meydenbauer Center – their 2009 Rate sheet is at the end of this packet. Please contact Tony Hartrich if you need assistance coordinating with the Center thru the vendorsupport@waurisa.org.

Booth setup will be May 4th from 8:00 am to 4:00 pm while the pre-conference workshops occur in nearby rooms. Meydenbauer Center can accept booth materials for storage overnight. If you require advance shipment of your materials, please request information on how to do this from Tony Hartrich.

The exhibitor hall will be open from 8:00 – 8:00 on Tuesday, with the evening social event planned from 6:00 – 8:00 in the exhibitor hall. On Wednesday, the exhibitor hall will be open from 8:00 – 3:00, at which time the two hour booth break-down will commence.

Waurisa
May 4th-6th
revised Feb 18th

Non Profit Tables

Open to below

Rainier Terrace

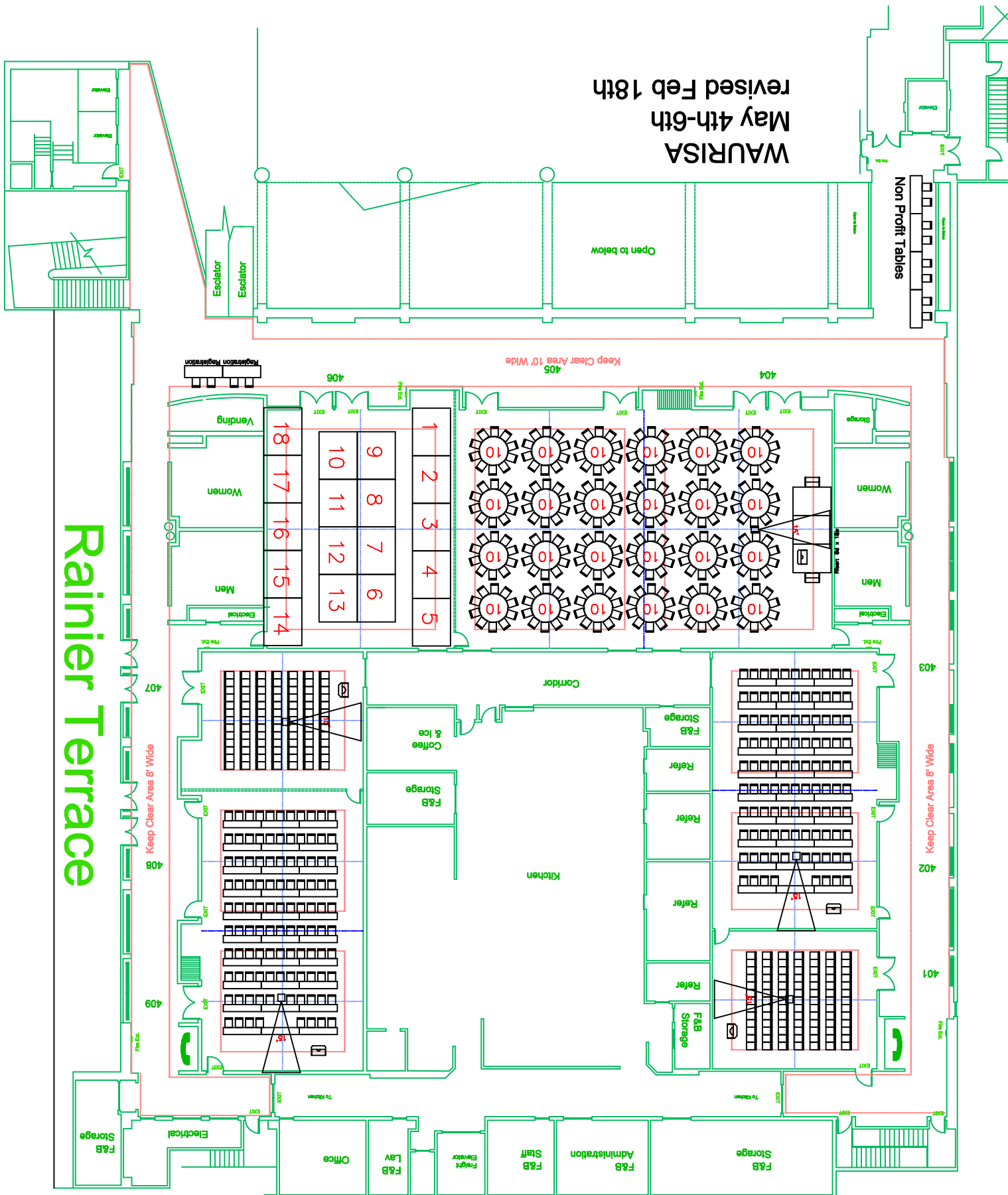

MEYDENBAUER CENTER

2009 Rate Sheet

>Services and Equipment

Meydenbauer Center offers comprehensive in-house services and professional personnel to ensure seamless coordination of your event needs. Meydenbauer Center is the exclusive provider of all telecommunication, data and internet services for the facility. Audio Visual (AV) Factory is the preferred in-house supplier of audiovisual services at Meydenbauer Center. As a full-service audiovisual company, AV Factory provides all of the audiovisual rental equipment, video projection, teleconferencing, show production, staging, lighting packages, and professional technicians to assist with all of your event needs. AV Factory's price sheet is provided on the audiovisual page of this packet. Your guest services manager is your single point of contact throughout the planning phase of your event to coordinate all of the equipment and services required for your event.

STANDARD ROOM RENTAL Includes one room set-up per day, per room configuration including:

- Theater, classroom, conference or banquet-style set
- Up to five skirted tables for registration purposes
- One lectern
- One wired, handheld microphone
- Pull down screen (fixed location)
- One digital telephone (dial 9, local calls) at registration only (on request)
- Two pieces of riser (if space allows)
- Center Hall rental includes up to ten pieces of riser or staging or five pieces for half-hall rentals
- Head table water service
- Electricity, 2—regular wall outlets up to 4,000 watts total at registration only
- One white board with pens and eraser (on request)
- One event radio
- Water cooler at back of room
- Two complimentary reserved parking passes
- Does NOT include Executive Meeting Service amenities

EXECUTIVE MEETING SERVICE Add 20% to applicable room rate.

- Available for classroom, round table or conference style sets
- Table linens
- Skirted front tables in classroom set
- Water pitchers and drinking glasses
- Note pads and pencils/pens
- White board and pens (4 total)
- Laser pointer (upon request)

General Telecommunications

The Convention Center has the capacity to accommodate a large number of analog or multi-line digital phones, data connections, internet access and ISDN lines, along with a host of ancillary services such as web casting, video conferencing, etc. Meydenbauer Center provides all of the above telecommunication and connectivity products and services so there is no need to contact the local phone or internet companies to arrange service.

WI-FI Access

Meydenbauer offers free wireless internet access in the public lobby spaces. With a wireless enabled device, guests can establish a connection to the "freemeydenbauer" network, the user is redirected to meymeydenbauer.com and logged into the HotSpot Gateway with free access at 128kbps. You may also order wireless connections for meeting rooms for a fee.

Data

Meydenbauer Center is fully wired to easily provide connectivity to event management, exhibitors and attendees throughout the facility. Meydenbauer offers bandwidth from 56k to shared 12mbps as our standard pipe into the facility. We can also provide additional bandwidth (up to full DS3) at the client's request with appropriate lead time. Our bandwidth is delivered via our internal gigabit fiber backbone with 100/1000mbps speed to the exhibit halls, meeting rooms and public spaces.

Meydenbauer Center is the exclusive provider of all telecommunication, data and internet services for the facility. Our offerings include: Standard 100/1000mbps data delivery via CAT5 and fiber throughout exhibit, meeting and public spaces.

- Networking services (VLANs, DHCP or Static IP addressing)
- Phone lines: Single line analog and multiple line digital phones
- ISDN services (with 10 days of lead time)
- Wireless LAN – currently available in public spaces can also be reconfigured to support event specific needs (please call for details)
- Video conferencing services and equipment (through Audio Visual Factory)
- Customized services based on client requests

Please note that clients who wish to bring in an outside internet service provider will pay a \$300 per line patch fee and the equivalent of Meydenbauer Center per megabit rates for each megabit of outside pipeline delivered.

Electricity

Whether you need 5 amps to power a laptop and an LCD projector, big power for a full lighting production or a distributed electrical network for trade show exhibitors, Meydenbauer can configure, route and hook up the electricity you need. With advance notice on-site electricians can assist in specialty hookups.

>Services and Equipment

Rigging

Meydenbauer Center's main exhibit hall has 31' ceilings with structural beam support capable of holding flown show production gear. Qualified riggers are available through AV Factory or clients can contract their own professional riggers.

Advance rigging plots may be required for some installations and all installed rigging is subject to inspection by Meydenbauer Center staff. Meydenbauer Center reserves the right to direct changes for public or building safety reasons.

EVENT SERVICES AND SUPPLIES

Current applicable sales tax will be charged on all equipment and labor. All prices are per day, unless otherwise noted.

Miscellaneous Equipment Rental

Coat rack	No charge
Dance floor up to 21' by 21'	\$200
Dance floor 24' by 24' to 40' by 40'	\$300
Flags with stands (USA, Washington or Canada)	No charge
Piano (tuning is additional at prevailing rates)	\$150
8' pipe and drape (per linear foot)	\$2.50
Radio – additional per day	\$15
Radio head set per day	\$5
Radio delivery and pick-up (if applicable) per order	\$30
Safe (18"H x 12"W x 12"D interior dimensions)/day	\$50
Water cooler (additional)	\$10
Water (5 gallon bottles)	\$5

Tables and Chairs

Chair	\$2.50
6' x 30" table	\$7
8' x 30" table	\$7
6' x 18" classroom style table	\$7
8' x 18" classroom style table	\$7
60" round	\$7
72" round	\$7
Dressed and skirted table with linen	\$16
Additional linen each	\$5
Additional skirting each	\$10

Risers and Staging

Riser with skirting per section	\$15
6' x 8' sections, 16", 24", 32" heights	
Stage with skirting per section	\$25
8' x 8' section, 4'-6' heights	

Banquet Table Accessories

Silk/dried floral arrangements/centerpieces	\$10
Banquet linens, special colors	Custom rate

Exhibit Booth Package

Up to 30 booths (per booth per event)	\$35
Includes 8' x 10' pipe and drape booth, 1-8' dressed table, 2 chairs	
Add electricity (5 amps) (per booth per event)	\$50

Electrical Services

5-amp (600watts) 120v per event	\$54
10-amp (1200watts) 120v per event	\$76
20-amp (2400watts) 120v per event	\$119
NEMA-L6-20 208v per event	\$168
NEMA-L14-20 208v per event	\$168
NEMA-L21-20 208v per event	\$194
NEMA-L6-30 208v per event	\$194
NEMA-L14-30 208v per event	\$194
NEMA - L21-30 208v per event	\$273
60-amp 3ph. 208v per event	\$315
100-amp 3ph. 208v per event	\$567
200-amp 3ph. 208v per event	\$965

Telecommunications and Data Services

Standard telephone-analog	\$185 / event
Multi-line telephone-digital	\$150 / event
Telco patch from D-Marc	\$150 / event
Internet Hookup – 1 MBps	\$1200 / event
Each Additional 1 MBps	\$1000 / event
Vendor High-speed Internet connection (1 hook-up per exhibit booth)	\$350 / event
Other fixed bandwidth or configurations	Please inquire
V-LAN	Please inquire
ISDN standard (10-day notice required)	Please inquire

Event Personnel

Rates quoted are per hour, unless otherwise noted

IT Specialist	\$75
Electrician, licensed (minimums may apply)	\$70-\$130
Cleaning personnel/conversion crew, 4 hr. minimum (see your Guest Services Manager for an estimate)	\$25
Booth cleaning per booth	\$35
Coat check, with tickets, 4 hr. minimum	\$30
Door guard/badge checker, 4 hr. minimum	\$30
Emergency medical team (2EMTs – 4hr. min.)	\$80
Police officer, 4 hr. minimum	\$60
Security officer, 4 hr. minimum	\$30
Traffic attendant, 4 hr. minimum	\$23
Ushers, 4 hr. minimum	\$23
Holiday rates vary, please call for pricing	

Office Services/Supplies

Coat check tickets (per 250 count)	\$15
Copies per page	\$.25
Send fax/per page	\$1.50
Receive fax/per page	\$1

Event Services

Freight receiving/storage per 100wt	\$40
Each additional 50 lbs	\$20
Forklift w/ operator	\$50
(Available w/advance notice–per 1/2 hr.)	
Scissors lift per day	\$110
Re-key door lock per lock	\$20

Trash removal

4 yard recycle bin (first 3 free, charge for add'l)	\$100
Trash (first compactor load free, charge for add'l)	\$175
Pallet/crate removal each	\$25

Parking

Additional reserved parking pass per day	\$24
In/out parking pass per day	\$20

>Audio Visual

Audio Visual Factory is the preferred in-house supplier of audiovisual services at Meydenbauer Center. As a full-service audiovisual company, AV Factory provides all of the audiovisual rental equipment, video projection, teleconferencing, show production, staging, lighting packages, and professional technicians to assist with all of your event needs. AV Factory is also the exclusive operator of Meydenbauer Center's house sound system. Your Guest Services Manager is your single point of contact throughout the planning phase to coordinate all of the equipment and services required for your event.

AUDIO VISUAL SERVICES AND SUPPLIES

Current applicable sales tax will be charged on all equipment and labor. All prices are per day, unless otherwise noted.

Projection Equipment

Computer/Video Projectors

LCD XGA (1024x768) (2000 Lumens)	\$350
DLP XGA (1024x768) (3500 Lumens)	\$500
LCD XGA (1024x768) (4500 Lumens)	\$800
LCD XGA (1024x768) (6500 Lumens)	\$1000
LCD XGA (1024x768) (10,000 Lumens)	\$1400

*Additional projectors available

Video Switchers/Scalers

Folsom ScreenPro Seamless Switcher	\$450
Folsom ScreenPro II Seamless Switcher	\$700
Folsom ImagePro SDI	\$250
Folsom PresentationPro I	\$350
Sony DSC 1024 Scan Converter	\$150
Panasonic MX-70 Video Mixer	\$350
VGA Switcher (4x1)	\$45
RGB Switcher (4x1)	\$45
Video/VGA DA	\$45

Projection Screens

6'x6' (Tripod)	\$35
8'x8' (Tripod)	\$35
10'x10' (cradle)	\$35

Fastfold Screens

Front or Rear Projection w/ Black Dress Kit	
6'x8'	\$120
7.5'x10**	\$150
9'x12**	\$195
10.5'x14**	\$250
12'x16**	\$350
15'x20**	\$500

*16:9 Aspect ratio screen kits available

Computer Equipment

Monitors

15" LCD Flat Screen (1024x768)	\$100
19" LCD Flat Screen (1280x1024)	\$150
24" HD LCD Flat Screen (1920x1080p)	\$250
32" LCD Flat Screen (1362x768)	\$200

Computers

Laptop Computer W/ MS Office*	\$150
Desktop Computer W/ MS Office*	\$225
Wireless Mouse	\$45
Wireless Powerpoint Remote	\$45

* Custom Configurations Welcome.

Video Equipment

Video/Preview Monitors

8" Preview Monitor	\$45
13" Preview Monitor	\$75
27" Panasonic Video Monitor	\$75
32" LCD Video Monitor	\$200
42" Plasma Screen w/stand	\$400

Video Player/Recorders

DVD Player	\$40
DVD-R Recorder	\$150
DV CAM Player/Recorder	\$250
VCR (NTSC)	\$40
Multi-region VCR (NTSC/PAL/SECAM)	\$75
Beta SP Player (PVW Series)	\$250
Beta SP Recorder (PVW Series)	\$350

Video Cameras/Lenses

Mini DV Camcorder w/ Tripod	\$225
Sony DVC Pro Camera	\$450
Sony D30 Camera w/Tripod & Controls	\$550
Sony CCU for D30 Camera	\$250
Long Throw Lens 42:1 for D30	\$700
Large Head Tripod for long lenses	\$125

Staging and Rigging

10' truss (12" box or triangle)	\$55
5' truss (12" box or triangle)	\$35
1/2 Ton Chain Motor	\$125
1 Ton Chain Motor	\$225
Set Pieces / Set Design	Inquire

Drape and Spandex

16-18' Black Pipe and Drape (per foot)	\$14/ft
16-18' Colored Drape: White, Burgundy, Blue, Grey	\$16/ft
15' x 15' Stretched Fabric (white)	\$250
15' x 20' Stretched Fabric (white)	\$500

Technical Event Support

AV Factory can provide your event with excellent technical support from the first planning meeting until your event concludes. We understand that each event is unique. Labor is charged by the hour or for a minimum number of hours depending on event/show needs.

>Audio Visual

Audio Equipment

PA Systems

PA Systems require labor and may require rigging material --please inquire

Small PA System \$125

1 Powered Speaker w/stand, 1HH Mic w/cord and stand, 4 Channel Mixer

Medium PA System \$150

2 Powered Speakers w/stands, 1HH Mic w/cord and stand, 4 Channel Mixer

Large PA System \$350

4 Powered Speakers w/stands, 1HH Mic w/cord and stand, 6 Channel Mixer

EAW NT59 PA System \$750

4 Speakers, 2 subs, 1 HH Mic w/cord and stand, 16 Channel mixer

McCauley M-Line Compact Line Array \$1500

8 speakers, 2 Flown subs, Lab Gruppen amps, Podium Mic, 16 Channel Mixer

McCauley MLA3 Line Array \$2500

12 Speakers, 2 Flown subs, Lab Gruppen amps, Podium Mic, 16 Channel Mixer

A La Carte Audio Equipment

Microphones

Wired Handheld Microphone	\$25
Wired Lavalier Condensor Microphone	\$30
PZM Crown Microphone	\$35
Wireless Microphone (Lavalier or handheld)	\$100
Countryman E6 headset***	\$75

***must be used with a wireless kit

Mixers

Shure 4 Channel (4 mic Inputs)	\$30
Mackie 1202 (4 mic/4 Stereo Line Inputs)	\$45
Mackie 1402 (6 mic/4 Stereo Line Inputs)	\$60
Mackie 1604 (16 channel)	\$75
Mackie 24 channel mixer	\$110
Crest HP832 (32 channel)	\$300

Speakers

DB Opera Amplified Speaker (ea)	\$75
EAW NT59 Amplified Speaker (ea)	\$125
EAW NT59 Amplified Subwoofer (ea)	\$125

Audio Player/Recorder

CD, CD-R Disc Player, MP3 Player	\$40
DAT Digital Cassette Recorder	\$75
5 Disc CD Player	\$60
CF/Hard Disk Recorder	\$150
Cassette Player/Recorder	\$75

Lighting Equipment

Lighting Fixtures

ERS 575	\$40
PAR 64/575	\$40
Fresnel	\$30
Mini ERS	\$25
Pinspot	\$30
Color Kinetics Colorblast 12	\$85
Moving Lighting Fixtures	Inquire

Lighting Consoles

NSI Controller	\$75
ETC Express 24/48	\$150
Fat Frog 48 channel	\$150
Leprecon 612	\$75
Leprecon 624	\$100

Dimmers

Leprecon MX 12CH/2K Dimmer Rack	\$150
Scrimmer Stick	\$50
4 Channel Dimmer	\$50

Miscellaneous

Gobo – Glass or Steel	Inquire
Avenger lighting Stand	\$50
Trouperette Spotlight	\$100

Conference Aids

Overhead Projector	\$30
35mm slide projector w/ remote	\$30
Slide Tray	\$5
Slide to Video Unit	\$150
Elmo Visual Presenter/Document Camera	\$250
*requires an LCD projector	
Wireless Powerpoint Presenter	\$45
Laser Pointer	\$20
Conference Phone	\$75
Gentner Conference Phone System	\$150
Assisted Hearing System (6 wireless)	\$100
Wired Speaker Timer	\$65
Wireless Speaker Timer	\$85
Digital Countdown Clock	\$150
Wired Clearcom Belt Pack & Headset	\$30
4-Station Wireless Clearcom Package	\$450

Flipchart with pens & paper	\$30
Flipchart (stand only)	\$20
Whiteboard w/pens & eraser	\$30
26" – 48" Cart w/skirt & power strip	\$25
Safelock Stand	\$15

*Additional equipment available – please inquire as to anything required.